

KEY FRAME PLAN
SCALE 1:5000

LEGEND:	
PLANNING BOUNDARY	
2.65m PALISADE FENCE OR AS NOTED	
POST AND RAIL STOCK FENCE OR AS NOTED	
PROPOSED BUILDING	
NEW ROAD HOT ROLLED ASPHALT TO DOE SPECIFICATION FOR ROAD WORKS	
NEW ROAD	
FINISHED LEVELS SHOWN TYPICAL	+XX.XX
INDICATES ROAD SIDE FILTER DRAINS. MAIN ACCESS ROAD DOUBLE CROSS FALL. SMALLER INTERNAL ROADS SINGLE FALL TOWARDS KERBS.	
INDICATES PROPOSED STORM WATER SEWER & MANHOLE WITH REFERENCE & INVERT LEVEL	

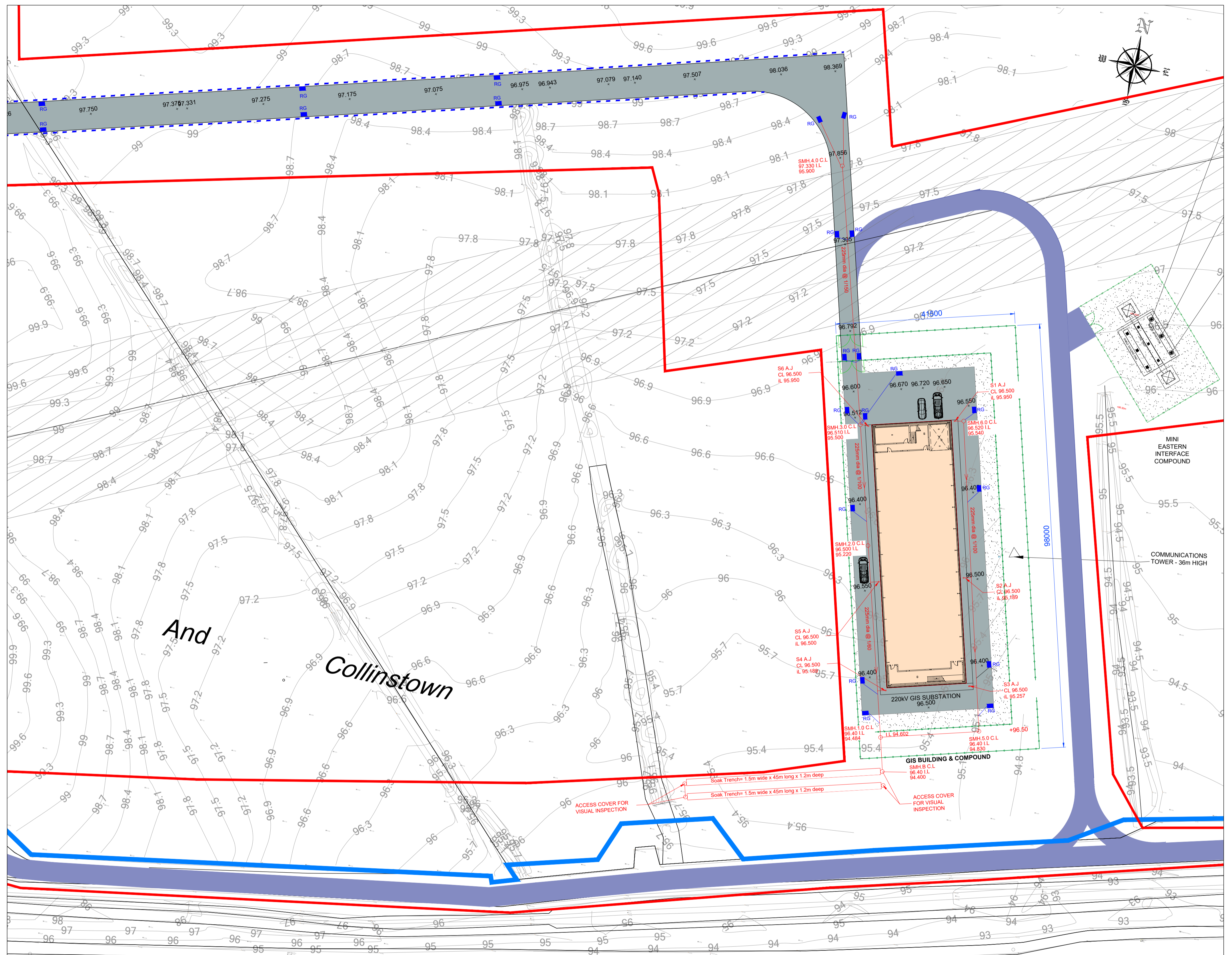

KEY FRAME 3
SCALE 1:500

Rev.	Modifications	By	Date
P1	PLANNING ISSUE	BB	11.02.22

NOTES:
1 FIGURED DIMENSIONS ONLY TO BE TAKEN FROM THIS DRAWING.
2 THIS DRAWING TO BE READ IN CONJUNCTION WITH ALL OTHER RELEVANT DRAWINGS AND SPECIFICATIONS.

© COPYRIGHT OF



Email: info@halston.ie
Tel: 094 9010111

IHUB BUILDING
WESTPORT ROAD
CASTLEBAR
CO. MAYO.
F23 K162

Client	LUMCLOON ENERGY
Project	LEL GIS, CASTLEOST CO. WESTMEATH
Title	PROPOSED SURFACE WATER DRAINAGE LAYOUT - SHEET 2 OF 2
Stage	PLANNING

Drawn	Checked	Approved
BB	WD	CS
Date	Dec 2021	
Scales	AS SHOWN (A1)	
Sheet	1 of 1	Sheet Size A1
Job No.	SEP-0347	Rev P1
Dwg. No.	0347-PL-2005B	